



IWT Infrarot-Wärmetechnik GmbH

Infrared-Fields, Infrared-Equipments, Components



INFRARED TECHNOLOGY FOR INDUSTRIAL USE



IWT Infrarot - Wärmetechnik GmbH / Heegwaldring 10 / D – 63694 Limeshain
Tel: +0049(0)-6047-950-850
www.iwt-infrarot.de
info@iwt-infrarot.de



IWT Infrarot-Wärmetechnik GmbH

INFRARED EQUIPMENTS FOR INDUSTRIAL USE



FLEXIBEL
STABLE
ALL WAVELENGTHS
FOR DIFFERENT
INDUSTRIES

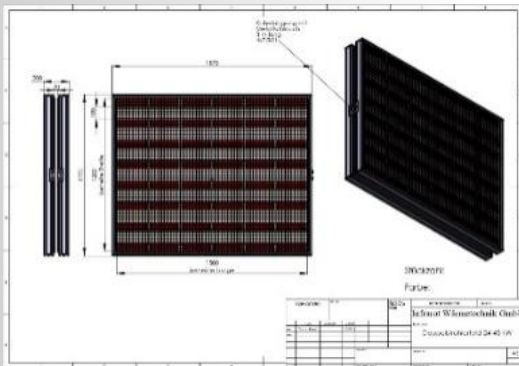

INFRARED fields are produced by IWT with each emitters that are available on the market. So our customers are not fixed to a special type they can choose the emitters and wavelength what will have the best efficiency.

The dimensions of the radiator fields are freely selectable and are limited only by the technically possibilities..



The outer frame is made from painted steel or by aluminium profiles. This guarantees a maximum in stability and unlimited possibilities to fix the system.

Depending on the kind of emitters the reflectors are designed individual.

The limit of the specific power is high, equipment's with more than 400 KW/² have been built and are working without any issue.

IWT Infrarot-Wärmetechnik GmbH

INFRARED EQUIPMENTS FOR INDUSTRIAL USE

FOR CONTINUOUS MOVE

Often used are INFRARED systems for heating processes, where the material is driven by a continuous speed.

The units often need a very high specific power. Mostly used are emitters with a very quick response time to protect the goods against over heating in case of emergency stop.

Very important are also own zones at both sides as compensation of the lost of energy at these locations.

We respect all this requirements from the beginning.

We respect all these requirements from the beginning and choose the emitters and the power individually for each customer that obtain the most benefits , from the commercial and technical point of view.

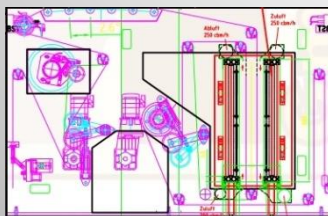
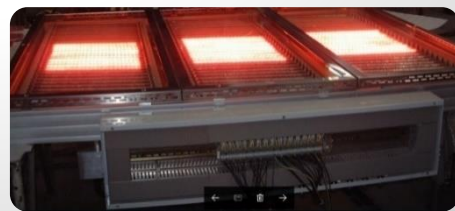
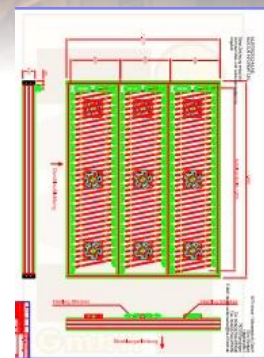

IWT Infrarot-Wärmetechnik GmbH

INFRARED EQUIPMENTS FOR INDUSTRIAL USE

FOR RAPID CYCLING PROCESSES

When using Infrared for cycling processes the material stays for a defined cycle time under the IR zone.

Mostly it is important, that the temperature tolerance is small, especially by using temperature sensitive goods.

Already the configuration of the emitters will help to have a continuous temperature.

But mainly it is important to divide the lamps in different zones, most effective if each emitter is controlled.

Intelligent combinations of closed-loop regulations and controlling of the IR-lamps will realize a very small temperature tolerance.

Comprehensive process visualization facilitate the adjustment and operation.

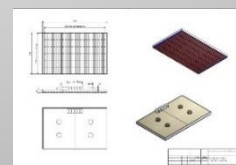
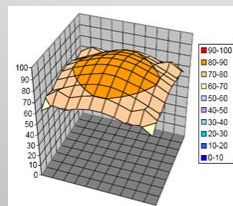
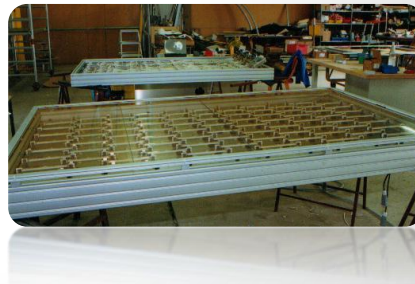
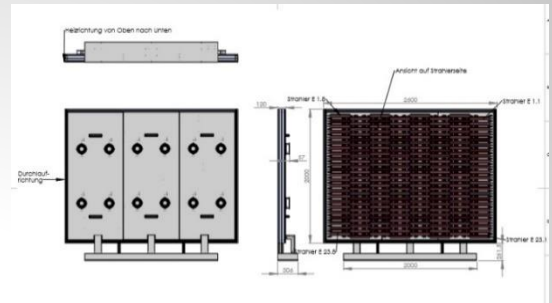

IWT Infrarot-Wärmetechnik GmbH

INFRARED EQUIPMENTS FO INDUSTRIAL USE

INFRARED WITHOUT LIMITS: SPECIAL INSTALLATIONS

Infrared projects which are more than a delivery of an emitter panel, are combined in “special installations”. When a complete unit with conveyer, air supply and more is requested we do not leave our customer alone.



In this cases IWT Infrarot-Wärmetechnik GmbH design and built the complete equipment, right up to the installation and commissioning.

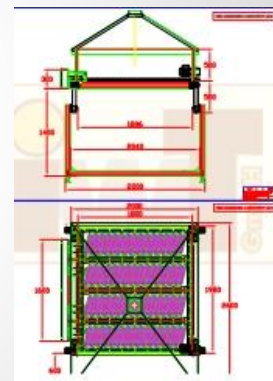

These are application for the activation of adhesives, curing or anneal of textiles and plastics, drying of painted wind energy rotors, heating of GFK/CFK CFK/GFK materials and many more.



IWT Infrarot-Wärmetechnik GmbH

INFRARED EQUIPMENTS FOR INDUSTRIAL USE



POWDER COATING AND PAINT OVENS

Infrared ovens are used to cure powder coatings and paint. The ovens are installed as pre-heating zones in front of convection ovens or as a complete unit to use INFRARED for the complete process.

Energy consumption is optimized by using the emitters only when needed and by switching them on and off parallel to the continuous line speed.

Only the painted objects are heated, the complete peripheries will remain nearly cold.

The emitters are controlled permanently against malfunction.

Many variations have been built, starting with a simple portal through to several tacts, but always designed to reach highest lifetimes under toughest conditions.

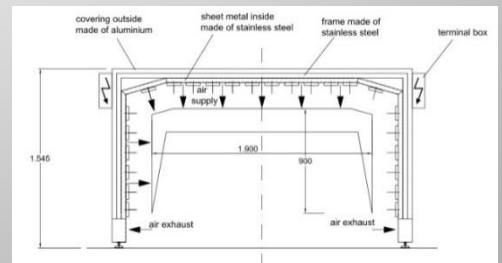

IWT Infrarot-Wärmetechnik GmbH

INFRARED EQUIPMENTS FOR INDUSTRIAL USE

OVENS

There are more applications to use INFRARED energy:

Anneal of Carbon semi-finished products, heating of plastics, drying of airplane tail units.

IWT Infrarot-Wärmetechnik GmbH is a specialist for applying a solution with radiation energy. Also and especially in complicated starting positions.

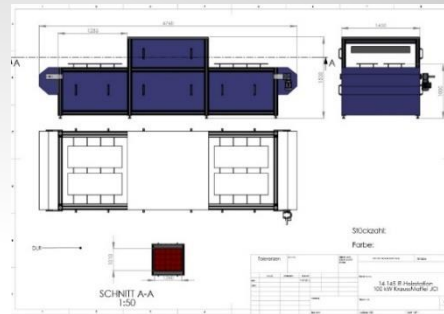

Project: AIRBUS Bremen, 12 x 4 m Infrared Dryer for curing of Aircraft Tails

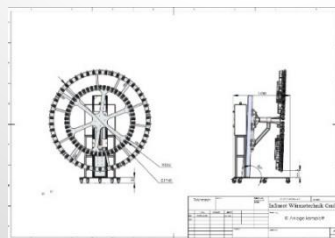

12 m IR Dryer for AIRBUS Bremen, built in 2012.





IWT Infrarot-Wärmetechnik GmbH

Infrared-Fields, Infrared-Equipments, Components

Founded 1994, the IWT Infrarot-Wärmetechnik GmbH has made a name of itself on the market all over the world.

We project, design, produce and install Infrared-equipments for industrial use up to the commissioning and ready for operation.

Most of our installations are tailormade. Made in close collaboration with our customers.

If the process is not known in detail we use our INFRARED laboratory to find out what kind of emitter and configuration is the best to find the optimized solution from commercial and technical view.

Large experience, a plenty of references and independence from the manufacturer of the emitters:

This performance you can have only from us: IWT Infrarot-Wärmetechnik GmbH

